

GENERAL NOTES

1. Site Plan taken from 20190041 Site Plan - Current.dwg provided by Walker Projects, and 2016 TREE assessment.dwg and Canterbury Site Plan base_CAD2010_2.dwg provided by 1080 Architecture. Building Plan taken from P2019014 Floor Plans_Final Revision.dwg provided by Walker Projects. The Contractor shall satisfy himself that all information, dimensions, patterns, and details are correct prior to construction.
2. Resort any discrepancies, errors or omissions to the Consultant immediately.
3. Variations and modifications to work shown will not be allowed without written permission of Consultant.
4. All dimensions are metric unless noted otherwise.
5. Contractor shall ensure that all areas adjacent to the work and new construction that may result from demolition and new construction are protected from damage.
6. Verify location of all utilities prior to starting construction. Underground infrastructure may not represent as-built conditions. Location of lines and values will be confirmed prior to detailed design.
7. Tree protection measures will follow RUFMS and RUFMS Appendix G - Tree Protection to ensure that damage to existing trees and root systems is minimized. Tree protection zones and grade changes at trees will be mitigated.
- 8.

LEGEND

	EXISTING TURF
	PROPOSED TURF
	PROPOSED PLANTING BED
	EXISTING TREE
	EXISTING TREE - OUT OF SCOPE
	EXISTING CAR BOULEVARD TREE
	PROPOSED DECIDUOUS TREE
	PROPOSED CONIFEROUS TREE
	EXISTING LIGHT STANDARD
	PROPOSED CATCH BASIN
	SHARED ACCESS AISLE
	PROPERTY LINE
	POWER LINE

EXISTING TREES ON PROPERTY - SUMMARY

PROPOSED	RETAIN	RELOCATE	REMOVE
22	29	1	20

EXISTING CITY OF REGINA TREES - SUMMARY

PROPOSED	RETAIN	RELOCATE	REMOVE
0	8	1	0

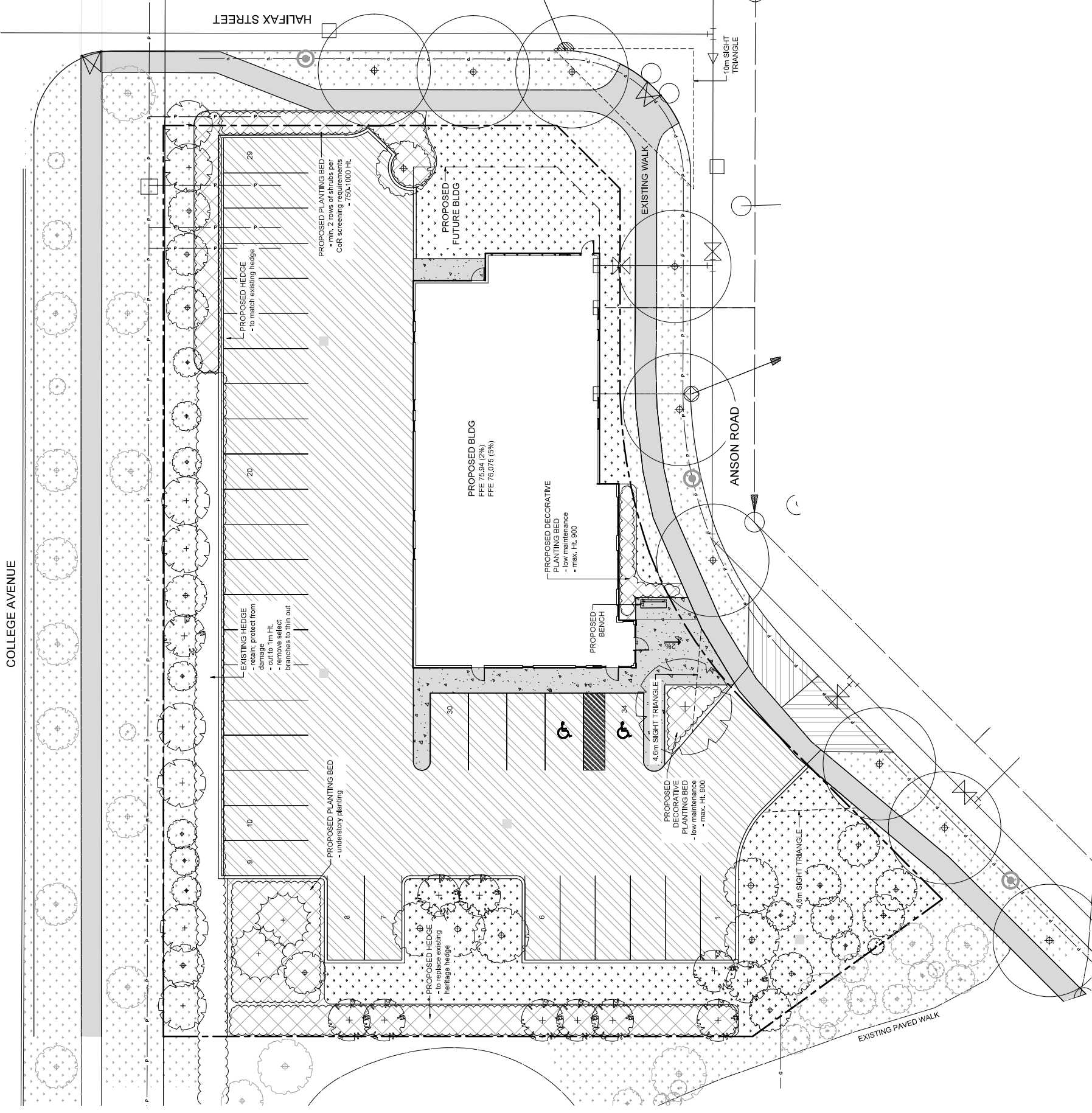

PRELIMINARY
NOT FOR CONSTRUCTION

REV.	DESCRIPTION	DATE
1	ISSUED FOR REVIEW	19-07-05
0	ISSUED FOR REVIEW	19-04-18

DRAWING TITLE
Landscape Concept Plan

PROJECT
Prairie Orthopaedics & Sports Medicine
Proposed New Office

CLIENT
Fiorante Homes & Commercial

DRAWN BY	DESIGNED BY	DATE	REVISION NO.
KT	LS	18Apr2019	R1

PROJECT NO. 19.013R
DRAWING NO. L1.1