

**JCK**  
**J.C. KENYON ENGINEERING INC.**  
 STRUCTURAL ENGINEERING CONSULTANTS  
 REGINA • SASKATOON  
 3008-25TH AVENUE, SUITE 103  
 REGINA, S4S 0K2  
 P: 306-765-8400  
 F: 306-765-8404  
 WWW.JCKENGINEERS.COM

**P3A**  
 Professional Property Assessment  
 CONSULTANTS  
 100 UNIVERSITY AVENUE, SUITE 100  
 REGINA, S4S 0A7  
 P: 306-765-8400  
 F: 306-765-8404  
 WWW.P3A.COM

**MachPHERSON**  
**Engineering Inc.**  
 Mechanical Consulting Engineers  
 220 - 2385 Albert Street, S4P 0K7  
 P: 306-765-8400  
 F: 306-765-8404  
 WWW.MACHPHERSON.COM

**R**  
**Ritenburg & Associates Ltd.**  
 Consulting Electrical Engineers  
 415-415 STREET, SUITE 100  
 REGINA, S4S 0K7  
 P: 306-765-8400  
 F: 306-765-8404  
 WWW.RITENBURG.COM

Rev.	Description	Date
1	Final V.A.D.	

Revision Schedule

SHERWOOD PLACE - PARKADE  
 ADDITION

REGINA, SASKATCHEWAN

**1:1**  
 SITE PLAN

DATE:	NOV 11, 2015
SCALE:	AS SHOWN
PROJECT NO.:	15001-23
CLIENT:	REGINA S4S

**A.X.X**

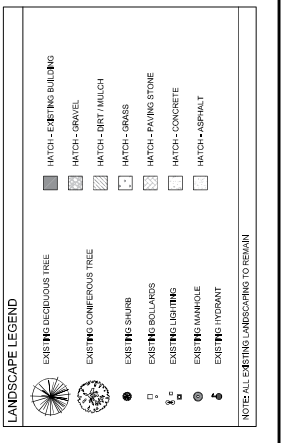
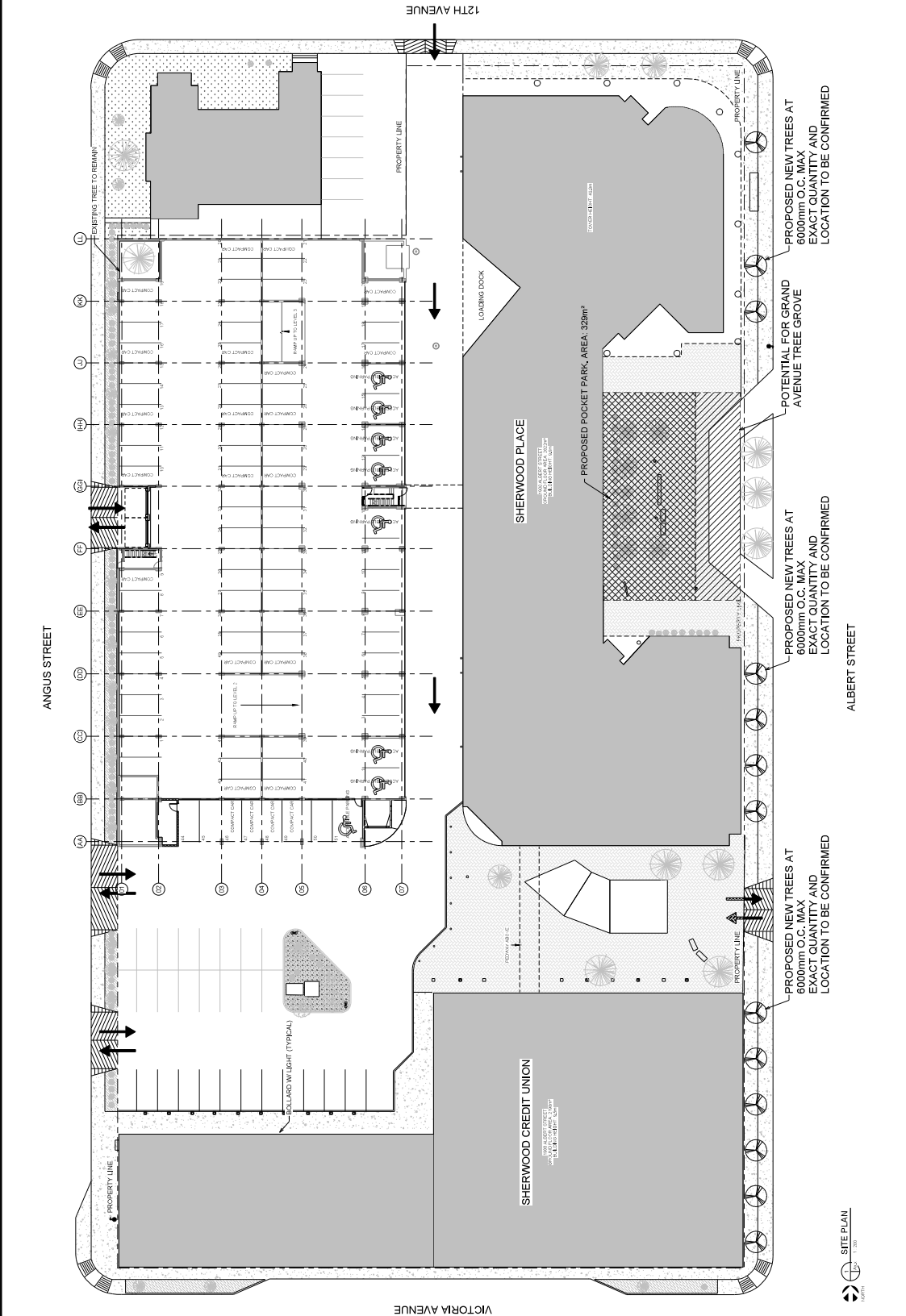

**PARKING - WITH NEW PARKADE**

LEVEL	TYPICAL	COMPACT	ACCESSIBLE	STALLS	TOTAL
U1 - EXISTING	35	17	42	94	94
U2 - EXISTING	35	17	42	94	94
U3 - EXISTING	35	17	42	94	94
U4 - EXISTING	35	17	42	94	94
U5 - PROPOSED	35	17	42	94	94
U6 - PROPOSED	35	17	42	94	94
U7 - PROPOSED	35	17	42	94	94
U8 - PROPOSED	35	17	42	94	94
U9 - PROPOSED	35	17	42	94	94
U10 - PROPOSED	35	17	42	94	94
<b>SUB-TOTAL</b>	<b>278</b>	<b>88</b>	<b>318</b>	<b>684</b>	<b>684</b>
<b>TOTAL</b>	<b>307</b>	<b>96</b>	<b>360</b>	<b>763</b>	<b>763</b>

ACCESSIBLE STALL CALCULATION: 3% OF 763 = 23 (MINIMUM PERMITTED BY CODE)  
 COMPACT STALL CALCULATION: 12.5% OF 763 = 96 (MINIMUM PERMITTED BY CODE)  
 EXISTING PARKING ON SITE - 150 PARKADE = 216 STALLS

**ZONING**

Chapter 5 - Table 5.2  
 Land Use Zone/Classification (U)  
 Land Use Zone/Classification (U) - 1 (Residential Medium Density)  
 Site Frontage: N/A  
 Site Depth: 30m  
 Min. Front Setback: 1.5m  
 Min. Side Setback: 1.5m  
 Min. Rear Setback: 1.5m  
 Max. Height: 10m  
 Max. Floor Area: 4500 sqm  
 Max. Garage Floor Area: 1500 sqm  
 Max. Parking: 12 cars

Chapter 5 - Table 5.3  
 Parking - Contoms  
 10.5 Development Regulations (max. 2.5 per Floor, 7.2c)  
 12.56m - Compoms  
 12.56m - Compoms  
 12.56m - Compoms

Notes:  
 N/A - Not Applicable  
 N/A - Not Applicable  
 N/A - Not Applicable  
 N/A - Not Applicable  
 N/A - Not Applicable  
 N/A - Not Applicable  
 N/A - Not Applicable  
 N/A - Not Applicable