

Appendix C

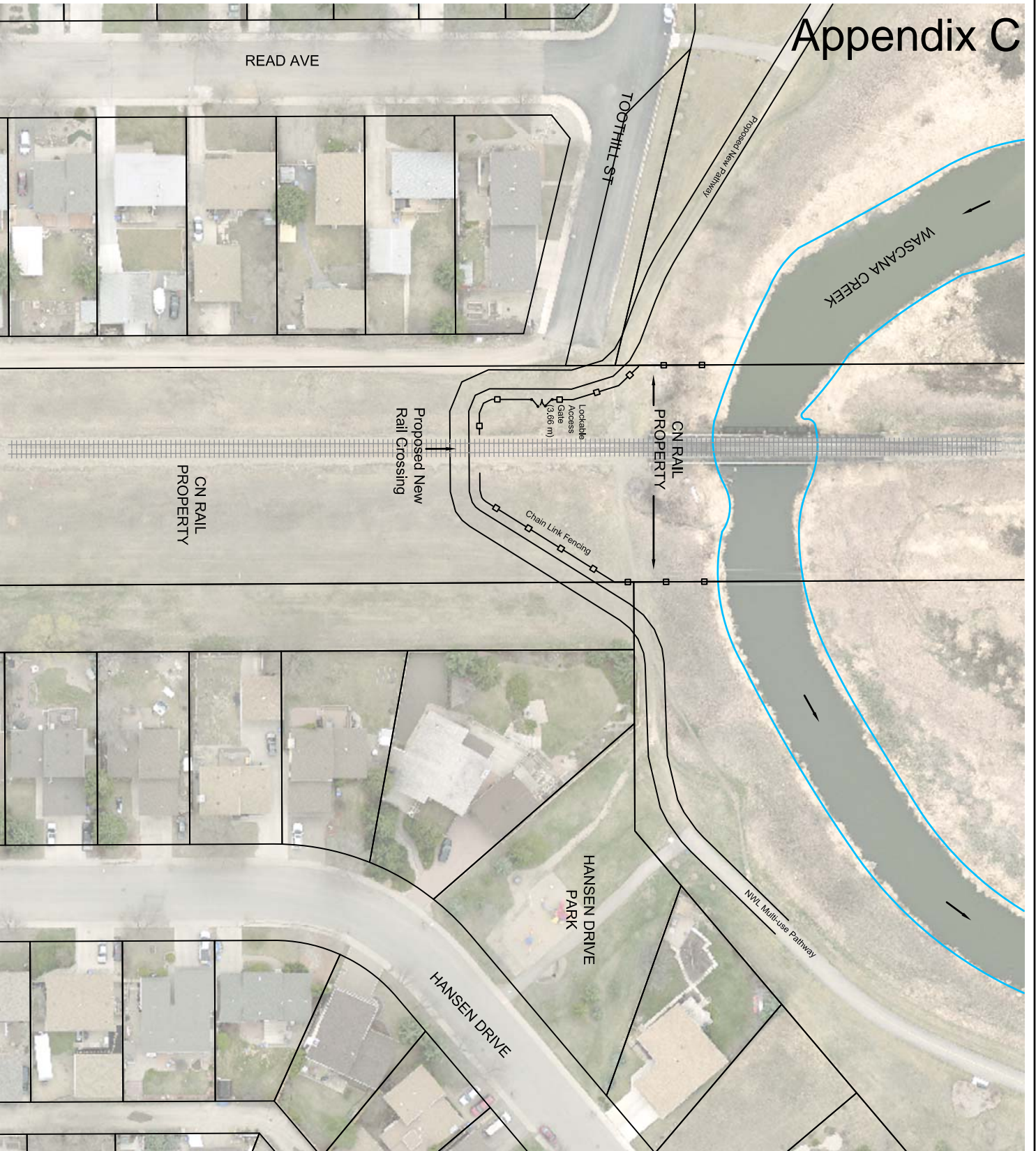

<p>City of Regina REGINA <i>Infinite Horizons</i></p>	
<p>Development Engineering City Operations Division Queen Elizabeth II Court - Box 1700 Regina, Saskatchewan S4P 2G5 Ph: (306) 777-7963 Fax: (306) 246-6023</p>	
File Number: 4800-014-02-99	
File Name and Path: CSD - NW Pathway - design\4.dwg	
Project: NWL Pathway CN Crossing	
Drawing Name: Site Location	
Agreement #2 Reference Map	
Date: Nov 20, 2017	
Designed By: MF	
Drawn By: MF	
Scale: 1:1000	
Sheet Number: L-1	